

EN



Unisj
MS TECHNOLOGY

Difficult to imagine now
what the future may hold



Chimiver[®]
"Il mondo del parquet"



2

The strength
of setting trends

Universal

For all types of traditional and pre-finished parquet flooring

traditional and pre-finished

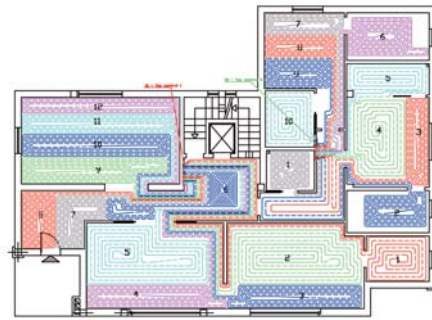

RDZ
Invisible comfort
SACILE (PN)

Approved by the best producers of subfloor heating systems



For all types of suitable sub-floors

for laying parquet flooring



User instructions

65%
contact

*Manual for laying to a
professional standard A.I.P.P.L.*

[Italian Wooden Floor Layers Association]

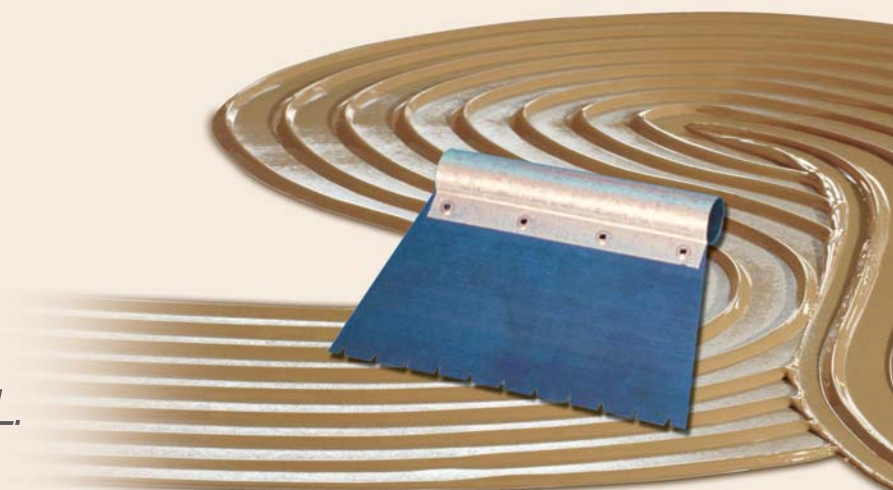

Lower consumption
- 30%

Compared with traditional two-component adhesives



Tenacity
prEN 14293/04 E

Tests passed brilliantly

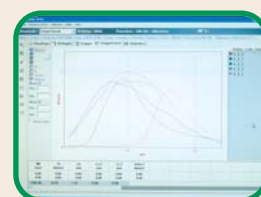

Reliable also when laying large formats

Elastic

Technical specification

Description

UNISIL is a prepolymer based, single-component adhesive with a silanic termination (MS technology), totally free from water, solvents, amines, isocyanates and epoxy resins. It hardens with atmospheric humidity and becomes resistant to water, temperature and ageing in approx. 36-48 hours. Recommended for gluing prefinished parquet onto marble, grit, ceramic or marble-chip floor tiles, etc. Ideal for gluing parquet onto sub-floors with radiant heating.

Characteristics

Mixture ratio	single-component
Application temperature	+15°C ÷ +25°C
Application	notched trowel n° 5
Maximum open time	1 h ⁽¹⁾
Hardening	36-48 h ⁽¹⁾
Specific weight	1,45 ± 0,02 g/cm ³
Solid content	100%
Coverage	700-1200 g/m ² depending on the type of sub-floor
Colour	oak
Storage stability	9 months ⁽²⁾
Packaging	15 Kg, 1000 ml, 600 ml
Tool cleaning	thinner DS (when adhesive is still fresh)

¹ at +20°C and 65% of R.H.

² in original sealed containers at temperatures between +10°C and +25°C.

Laying conditions

Sub-floor

Dry, clean, non-friable and not excessively rough sub-floor.

Sub-floor humidity

2.0% max for cement sub-floors.

1.7% max for cement sub-floors with radiant heating.

0.5% max for anhydrite sub-floors.

0.2% max for anhydrite sub-floors with radiant heating.

Humidity of wood

9% ± 2%

Other uses

Gluing panels for heat and acoustic insulation (cork, polyurethane foam, rock wool).

Gluing tiles on asbestos cement and chipboard panels.

Gluing wood and building materials (ceramics, gres-slabs) on metal supports.

How to use

The foundation, according to local regulations, must be dry, free from cracks, uniform and completely clean from the elements that can damage its adherence. Apply Unisil paying attention to lay the wood blocks side by side and knock them down well to make sure the adhesive glues well to the entire surface. Perfect adhesion to the sub-floor is insured if at least 65% of each wooden component is in direct

contact with the adhesive. If the sub-floor is porous or friable, we suggest to apply one coat of PRYMER SF 1105, PRYMER W 30 K or PRYMER FAST 500. Other compatible products are: PRYMER PUB 77 and PRYMER WAP 150. The drying time for the subsequent coats depends on the primer used (see technical datasheet). If you need to glue the parquet onto glazed sub-floors (such as ceramic, enamelled tiles or polished marble, etc.), roughen the entire surface with sandpaper (16, 24 or 36 grit) or a diamond tool, remove dust thoroughly, then apply PRYMER APA to improve adhesion (see technical datasheet). Sand the surface of anhydrite sub-floors thoroughly using 24 or 36 sandpaper; remove dust and apply primer using PRYMER SF 1105 (do not dilute) or PRYMER FAST 500 (diluted with DMC 50 thinner in 30%). Even PRYMER PUB 77 can be applied on the anhydrite sub-floors with DMC 50 thinner in a 70:30 ratio. UNISIL must be acclimatized at room temperature before being applied. Sand the floor after 3-4 days, depending on the atmospheric conditions and humidity level of the wood species used. The possible excess of glue can be removed with a cleaning humid cloth. In case of left over, seal the bucket properly by using both caps to avoid waste.

Warnings

The sub-floor temperature must be at least +12°C/+15°C. Do not apply the adhesive if the humidity in the working environment exceeds 75%. Do not install the parquet flooring if the walls or the ceiling have not yet dried (plastering, white washing, etc.). Never dilute the adhesive. Do not walk on the parquet floor surface for at least 24-36 hours after laying. Small quantities of methyl alcohol can be released during the drying phase.

This information is provided based on our best technical and application knowledge and represents general information and is not binding on our Company. Each specific case must be submitted to a practical test by the user who assumes responsibility for the final outcome of the work.

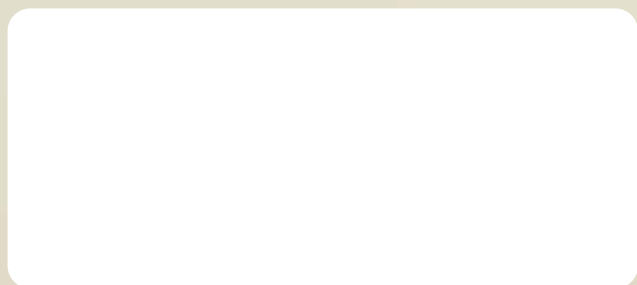

Authorised retailer

Chimiver[®]
"Il mondo del parquet"

CHIMIVER PANSERI S.p.A.
Via Bergamo, 1401
24030 PONTIDA (BG) - ITALY
Tel. +39 035 795031
Fax +39 035 795556
www.chimiver.com
info@chimiver.com

